



# BEVERAGE-AIR

|                 |      |
|-----------------|------|
| Project: _____  | AIA# |
| Item: _____     |      |
| Location: _____ | SIS# |
| Approved: _____ |      |

# WTFD48AHC WORKTOP DRAWER FREEZER

## WORKTOP FREEZER

### WTFD48AHC Worktop With Drawers & Foamed-In Place Backsplash Hydrocarbon Series

**MODEL:**  
WTFD48AHC-2-FIP



**5 Year Parts/Labor Warranty Available**  
**7 Year Compressor Warranty**

### CABINET CONSTRUCTION

- Stainless steel front, sides, door, drawers and grille (galvanized back & bottom)
- Interior liner is made of corrosion resistant aluminum
- Stainless steel worktop for added durability
- Foamed-in place backsplash
- Full electronic control
- Interior thermometer is standard
- Snap-in drawer gaskets
- Self-closing door with 120° stay-open feature, on cartridge style hinges
- Door opening includes low wattage, anti-condensate heaters
- Magnetic gasket attached to each door for positive seal
- Field-reversible door (hinge kit not included)
- Two (2) epoxy-coated steel wire shelves
- Upper and lower pull-out drawers accommodate 6" deep pans
- Stainless steel drawer frames supported on telescoping drawer slides
- Drawer slides include locking mechanism that prevents drawer from being inadvertently pulled off cabinet
- 6" Casters, (2) with brakes standard

### OPTIONS & ACCESSORIES

- 3 Year parts/labor standard, additional 2 year warranty available
- Stainless steel back
- Stainless steel interior
- 16 Gauge stainless steel top
- Additional shelves
- Shelf clips
- Right or left hinged door
- Locks (solid doors only)
- Bun rack
- Wire shelf divider
- Cutting board
- 3" Casters
- 6" Legs (stainless steel, black or seismic/flange)
- Low profile casters
- Roller kit
- Remote option\* (see note on back on page)

### REFRIGERATION SYSTEM

- Uses environmentally friendly, energy efficient R290 refrigerant, and meets all regulatory requirements for CARB, SNAP, DOE & more
- Adaptive defrost
- Epoxy coated evaporator coil
- Freezers capable of maintaining product temperature of -10°F



  
Please verify qualifying units by visiting:  
[www.energystar.gov/cfs](http://www.energystar.gov/cfs)

3779 Champion Blvd., Winston-Salem, NC 27105  
1-888-845-9800 Fax: 1-336-245-6453  
Beverage-Air.com Sales@bevair.com



# BEVERAGE-AIR

| MODEL                              | WTFD48AHC-2-FIP      |
|------------------------------------|----------------------|
| <b>EXTERNAL DIMENSIONAL DATA</b>   |                      |
| Width Overall                      | 48"                  |
| Depth Overall with Handle & Bumper | 32"                  |
| Height Overall with 6" Casters     | 39 5/8"              |
| Number of Drawers                  | 2                    |
| Drawer Openings                    | (2) 19 5/8" x 9 3/8" |
| Number of Door                     | 1                    |
| Depth with Door Open 90°           | 52 1/4"              |
| <b>INTERNAL DIMENSIONAL DATA</b>   |                      |
| NET Capacity (cubic ft.)           | 11.44                |
| Internal Width Overall (in)        | 44"                  |
| Internal Depth Overall (in)        | 15 3/8"              |
| Internal Height Overall (in)       | 23"                  |
| No. of Shelves                     | 2                    |
| <b>ELECTRICAL DATA</b>             |                      |
| Full Load Amperes                  | 5.0                  |
| <b>REFRIGERATION DATA</b>          |                      |
| Horsepower                         | 1/2                  |
| Capacity (BTU/Hr)                  | 1868                 |
| Heat Rejection (BTU/Hr)            | 2802                 |
| Charge (lbs/grams/ounces)          | 0.165 / 75 / 2.64    |
| <b>SHIPPING DATA</b>               |                      |
| Gross Weight - Crated              | 324 lbs              |
| Height - Crated                    | 35"                  |
| Width - Crated                     | 51"                  |
| Depth - Crated                     | 33"                  |

\*NOTE: Remote units are field wired and come with 6" legs.  
Refrigerant must be specified at time of order.

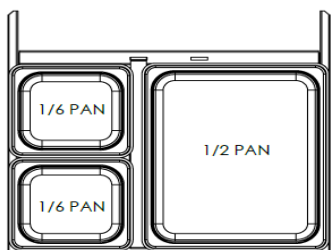

## Worktop Freezer Model: WTFD48AHC-2-FIP

### Model Views

Required Clearance: 3" Bottom & 2" Rear

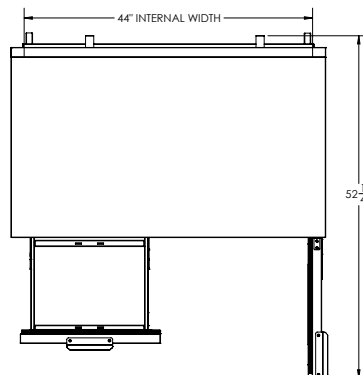

### PLAN VIEW

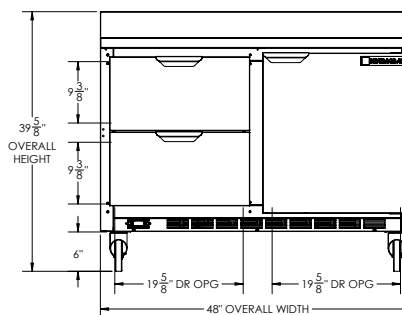

### ELEVATION VIEW

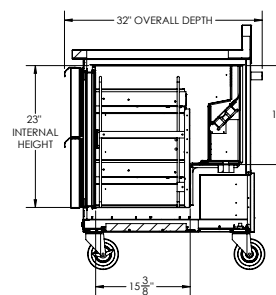

### SIDE VIEW

### ELECTRICAL CONNECTION



115/60/1  
NEMA 5-15P

Unit pre-wired at factory  
and include 8' long cord  
and plug set.



3779 Champion Blvd., Winston-Salem, NC 27105 1-888-845-9800 Fax: 1-336-245-6453 Beverage-Air.com Sales@beveair.com

an Ali Group Company



The Spirit of Excellence