



# BEVERAGE-AIR®

Project: _____	AIA# _____
Item: _____	
Location: _____	SIS# _____
Approved: _____	

## RID PASS-THRU REFRIGERATOR

RID18HC Half-Glass Door Bottom Mount Refrigerator  
Hydrocarbon Series

MODEL:  
RID18HC-HG

RID18HC BOTTOM MOUNT: RI SERIES PASS-THRU



5 Year Parts/Labor Warranty Available

7 Year Compressor Warranty

### CABINET CONSTRUCTION

- Stainless steel exterior and interior
- Full electronic control
- Interior LED light
- Five (5) shelves standard
- One piece grille
- Cartridge style hinges
- 120° Stay-open feature
- Snap-in magnetic door gaskets
- 3" Heavy duty casters with two brakes standard

### OPTIONS & ACCESSORIES

- 3 Year parts/labor standard, additional 2 year warranty available
- Epoxy shelves & clips
- 6" Casters or 6" legs optional
- Wire shelf dividers
- Right or left hinged door
- Remote option\* (see note on back page)

### REFRIGERATION SYSTEM

- Refrigeration system uses R290 refrigerant to comply with all environmental concerns
- Automatic, non-electric defrost
- Epoxy coated evaporator coil
- Maintains temperature between 36° and 38°F



Please verify qualifying units by visiting:  
[www.energystar.gov/cfs](http://www.energystar.gov/cfs)

3779 Champion Blvd., Winston-Salem, NC 27105  
1-888-845-9800 Fax: 1-336-245-6453  
[Beverage-Air.com](http://Beverage-Air.com) [Sales@bevair.com](mailto:Sales@bevair.com)



# BEVERAGE-AIR®

MODEL	RID18HC-HG
<b>EXTERNAL DIMENSIONAL DATA</b>	
Width Overall	27 1/4"
Depth Overall with Handles	32 5/8"
Height Overall	72 3/8"
Number of Doors	4
Depth with Door Open 90°	80 1/8"
Door Openings (in)	24" x 24 3/4"
<b>INTERNAL DIMENSIONAL DATA</b>	
NET Capacity (cubic ft.)	18.38
Internal Width Overall (in)	24 1/4"
Internal Depth Overall (in)	25 1/8"
Internal Height Overall (in)	Max 53" Min 46 5/8"
Number of Shelves	5
<b>ELECTRICAL DATA</b>	
Full Load Amperes 115/60/1	5.5
<b>REFRIGERATION DATA</b>	
Horsepower	1/4
Capacity (BTU/Hr)	1997
Heat Rejection (BTU/Hr)	2995.5
Charge (lbs/grams/ounce)	0.1875/85/3.0
<b>SHIPPING DATA</b>	
Gross Weight (crated lbs)	422 lbs
Height - Crated	76"
Width - Crated	30"
Depth - Crated	35"

\*NOTE: Remote units are field wired and come with 6" legs.  
Refrigerant must be specified at time of order.

## Bottom Mount Pass-Thru Half-Solid Door Model: RID18HC-HG

### Model Views

Required Clearance: 3" Rear & Bottom

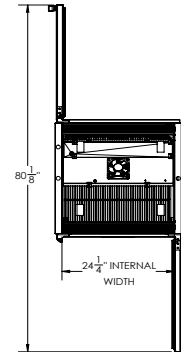

### PLAN VIEW

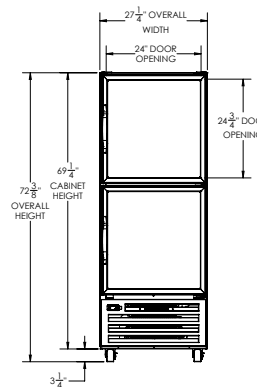

### ELEVATION VIEW

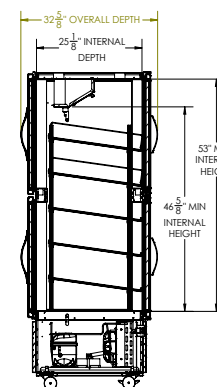

### SIDE VIEW

## ELECTRICAL CONNECTION



115/60/1  
NEMA 5-15P

Unit pre-wired at  
factory and include  
10.7' long cord and  
plug set.



3779 Champion Blvd., Winston-Salem, NC 27105 1-888-845-9800 Fax: 1-336-245-6453 Beverage-Air.com Sales@bevair.com

an Ali Group Company

