



BEVERAGE-AIR

Project: _____	AIA#
Item: _____	SIS#
Location: _____	
Approved: _____	

MT34™ MERCHANDISER: HINGED DOOR MODEL

MARKETEER™ MERCHANDISERS

MT34 Black Hinged Door Model
Hydrocarbon Series

**MODEL:
MT34-1B**



**5 Year Parts/Labor Warranty Available
7 Year Compressor Warranty**

CABINET CONSTRUCTION

- Standard cabinet exterior finish is heavy duty steel with a black baked on durable coating
- Heavy duty interior construction includes white coated steel
- Mechanical temperature control
- Modern one piece grille
- Double pane lowE argon filled glass doors feature outside pane that is tempered for added safety
- Door locks standard
- Self-closing hinged glass doors features, pocket door handles
- LED lighting
- Ten (10) epoxy coated shelves
- Leveling feet

OPTIONS & ACCESSORIES

- 3 Year parts/labor standard, additional 2 year warranty available
- Extra shelves and clips
- 3" Casters
- Visislide shelving kit

REFRIGERATION SYSTEM

- Uses environmentally friendly, energy efficient R290 refrigerant, and meets all regulatory requirements for CARB, SNAP, DOE & more
- Condenser is designed to be low maintenance, and energy efficient
- Automatic, non-electric defrost
- Epoxy coated evaporator coil



Please verify qualifying units by visiting:
www.energystar.gov/cfs

3779 Champion Blvd., Winston-Salem, NC 27105
1-888-845-9800 Fax: 1-336-245-6453
Beverage-Air.com Sales@bevair.com



BEVERAGE-AIR

Glass Hinged Door Model Model: MT34-1B

MODEL		MT34-1B
EXTERNAL DIMENSIONAL DATA		
Width Overall		39 1/2"
Depth Overall		27 1/2"
Height Overall		79"
Number of Doors		2
Depth with Door Open 90°		51 1/2"
Door Openings		14 3/8" x 54 1/2"
INTERNAL DIMENSIONAL DATA		
NET Capacity (cubic ft.)		26.12
Capacity 20 oz		300
Internal Width Overall (in)		39 3/8"
Internal Depth Overall (in)		21 5/8"
Internal Height Overall (in)		60 5/8"
Internal Height Useable (in)		55"
Number of Shelves		10
ELECTRICAL DATA		
Full Load Amperes 115/60/1		7.6
REFRIGERATION DATA		
Horsepower		1/2
Energy Consumption		6.174 kWh/day
Charge (lbs/grams/ounces)		0.1323 / 60 / 2.1
WEIGHT DATA		
Gross Weight - Crated		356 lbs
Height - Crated		84"
Width - Crated		42"
Depth - Crated		30"

Model Views

Required Clearance: 4" Top, Bottom, Rear, & Sides

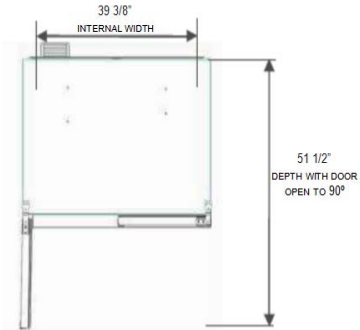

PLAN VIEW

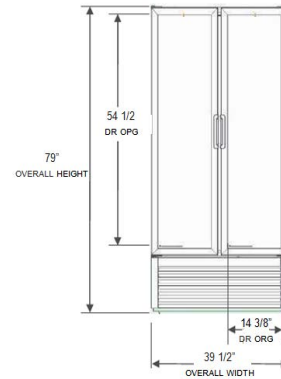

ELEVATION VIEW

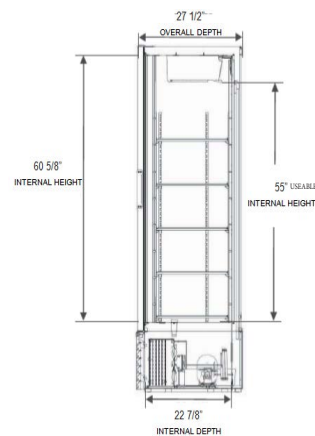

SIDE VIEW

ELECTRICAL CONNECTION



115/60/1
NEMA 5-15P

Unit pre-wired at factory and include 8' long cord and plug set.

