



"WE MAKE THE KITCHEN BETTER!"

ATOSA USA, INC.

Toll Free: 855-855-0399 Email: info@atosausa.com

www.atosa.com | www.atosausa.com

California, Colorado, Florida, Georgia, Illinois, New Jersey, Ohio, Texas, Washington

Undercounter Refrigerators

Standard Features

- Stainless steel exterior & interior with reinforced stainless steel top
- Environmentally friendly R290 refrigerant
- Electronic Temperature Controller
- Maintains temperatures between 33°F to 45°F
- Recessed door handle(s)
- Self-closing door(s) with stay open feature
- Magnetic door gasket(s) standard for positive door seal
- Pre-installed casters
- One(1) pre-installed shelf per section

Optional Accessories

- Extra shelves – includes 4 shelf clips per shelf
MGF8401GR/GRL shelf part #: W0402568
MGF36RGR shelf part #: W0402713
MGF8402GR shelf part #: W0402171
MGF8403GR shelf part #: W0402569
MGF8404GR shelf part #: W0402171 left/right shelf, part #: W0402570 middle shelf

For the best results of food preservation we recommend setting your refrigerator between 33 °F to 38 °F

1. Don't forget to leave the unit some room to breathe!
2. Please clean the condenser frequently to give the unit more fresh air.



2 YEAR PARTS AND LABOR WARRANTY
5 YEAR COMPRESSOR PART WARRANTY

MODELS:

MGF24RGR / MGF8401GR / MGF8401GRL
MGF36RGR / MGF8402GR / MGF8403GR / MGF8404GR



MGF8401GR



MGF8401GRL



MGF24RGR



MGF36RGR



MGF8402GR



MGF8403GR



MGF8404GR



MGF8401GR / MGF8401GRL
MGF8402GR / MGF8403GR
MGF8404GR

REV. 02/24



"WE MAKE THE KITCHEN BETTER!"

ATOSA USA, INC.

Toll Free: 855-855-0399 Email: info@atosausa.com

www.atosa.com | www.atosausa.com

California, Colorado, Florida, Georgia, Illinois,

New Jersey, Ohio, Texas, Washington

SPECIFICATIONS

Models	Door	Capacity (Cu.Ft.)	Shelves	Casters (inch)	Rated Current (A)	Voltage (V/Hz/Ph)	HP	Refrigerant	Exterior Dimensions (inch)	Net Weight (lbs)	Gross Weight (lbs)
MGF24RGR	1	4.8	2	2	2.3	115/60/1	1/7	R290	23 ^{13/16} ×25×32 ^{1/2}	106	128
MGF8401GR/GRL	1	7.2	1	2	2.3	115/60/1	1/7	R290	27 ^{1/2} ×30×34 ^{1/5}	137	172
MGF36RGR	2	8.7	2	2	2.3	115/60/1	1/7	R290	36 ^{5/16} ×30×34 ^{1/5}	162	212
MGF8402GR	2	13.4	2	2	2.3	115/60/1	1/7	R290	48 ^{3/10} ×30×34 ^{1/5}	192	231
MGF8403GR	2	17.2	2	2	2.8	115/60/1	1/5	R290	60 ^{1/5} ×30×34 ^{1/5}	218	265
MGF8404GR	3	21.1	3	2	2.8	115/60/1	1/5	R290	72 ^{7/10} ×30×34 ^{1/5}	254	315

PLAN VIEW

MGF8401GR

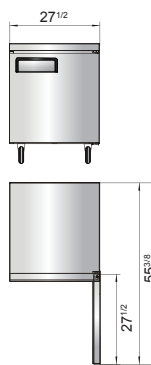

MGF8401GRL

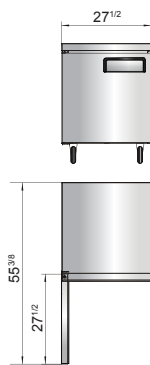

MGF36RGR

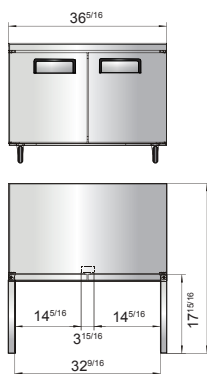

MGF8402GR

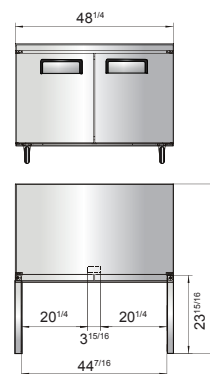

MGF8403GR

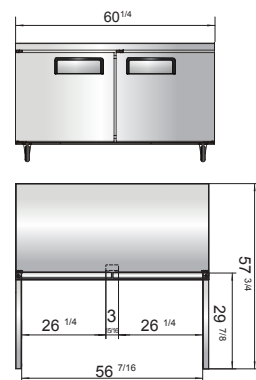

MGF8404GR

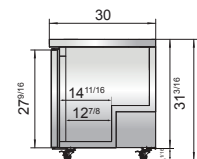
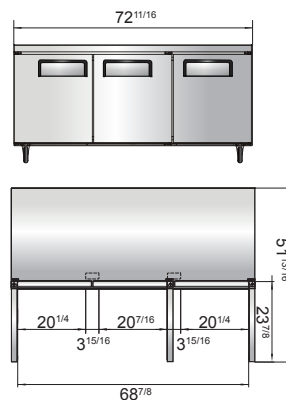

SIDE VIEW

MGF24RGR

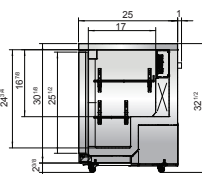
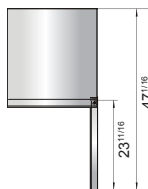

SIDE VIEW

Casters



Epoxy shelves



Rear grate



Temperature control



NEMA 5-15P

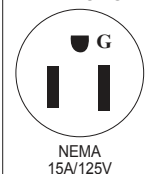

NEMA
15A/125V