

# CHEF BASE (FOUR DRAWER) SIDE MOUNTED CONDENSING UNIT



ECB82-86D4

ECB Series



## Refrigeration System

- Side mounted, self-contained and fully detachable Blizzard R290 condensing unit uses environmentally friendly, EPA-compliant R290 refrigerant with zero (0) Ozone Depletion Potential (ODP) and three (3) Global Warming Potential (GWP). Blizzard R290 is easily replaceable and requires no on-site brazing.
- Electronically commutated (ECM) fan motors achieve rapid cooling with less energy consumption.
- Full-length air duct ensures optimal cold air circulation.
- Time-initiated and temperature-terminated auto defrost cycle for seamless operation.
- Large capacity, corrosion-resistant condenser and evaporator coils.
- Self-maintaining, energy-efficient condensate drain pan requires no external drains or electric heaters.
- High performance, auto-reverse condenser fan motor supports compressor ventilation and condenser coil cleaning.
- Pressure relief devices allow rapid cabinet re-entry.
- Pre-wired and ready to plug, 115V/60Hz/1Ph, NEMA 5-15P

## Cabinet Construction

- Heavy duty stainless steel interior / exterior with rounded corners for a hazard-free workspace.
- Open spaced interior with no walls between compartments.
- Galvanized steel bottom and rear.
- 2.5" thick high density polyurethane insulation.
- 16-gauge stainless steel worktop has extra layer of high-grade insulation material and integrated air chamber/vents to redirect and mitigate heat. Prevents heat-induced warping of the worktop while keeping the cabinet cold and energy cost low.
- Thick gauge stainless steel corner guards keep mounted cooking equipment from sliding off the worktop.
- Heavy duty stainless steel grips offer secure maneuverability.
- 12-gauge metal caster brackets support additional weight of mounted cooking equipment.
- Six 5" swivel casters with locks on front set. Three front leg stabilizers standard.

## Recommended Operating Conditions

- A minimum clearance of 6" is required between the cooking equipment's heating element and the Chef Base worktop.

## Drawers

- Heavy duty stainless steel interior / exterior.
- 2.5" thick high density polyurethane insulation.
- Thick gauge, stainless steel drawer frames with low-friction ball bearings.
- Snap-in, heat resistant, magnetic drawer gaskets make cleaning and replacement an easy process.
- High strength, recessed drawer handles.
- NSF certified polycarbonate 4" deep pans (refer to the website for pan configurations).

## Temperature Control

- Multi-function digital controller with easy to read LED display.
- Factory preset temperature, 35°F. Temperature setting range from 33°F to 54°F.
- Audible overheat protection alarm for compressor and condenser coil.

## Options

- 3" swivel casters with locks.
- 3.5" – 6" height-adjustable and interchangeable legs.



| Type | Doors | Max Weight Support (Lbs.) | # of Pans | Refrigerant | HP  | Power V-Hz-Ph | Amps | Crated Weight | Exterior Dimensions |         |     |
|------|-------|---------------------------|-----------|-------------|-----|---------------|------|---------------|---------------------|---------|-----|
|      |       |                           |           |             |     |               |      |               | L                   | D       | H*  |
| REF  | 4     | 1084                      | 1x10      | R-290       | 1/3 | 115-60-1      | 2    | 550 lbs       | 86.25"              | 32.125" | 20" |

(†)Based on evaporating temperature of 23°F (-5°C) & condensing temperature of 131°F (55°C). (P) Product capacity is calculated based on standard industry figures. (\*) Reference plan view for clarification on caster/unit height. If dimensions and capacity are critical, please contact Everest Refrigeration. Blizzard R290 replacement is at the sole discretion of Everest Refrigeration. Specifications subject to change without notice.

# CHEF BASE (FOUR DRAWER) SIDE MOUNTED CONDENSING UNIT



## ECB82-86D4

## ECB Series

### DIMENSIONAL DATA

|                    |          |            |
|--------------------|----------|------------|
| External Dims.     | L        | 86.25 in.  |
|                    | D        | 32.125 in. |
|                    | H*       | 20 in.     |
| Crated Weight      | 550 lbs. |            |
| Doors/Drawers/Lids | 4        |            |
| Max Weight Support | 1084     |            |

### STORAGE DATA

|                                   |      |
|-----------------------------------|------|
| Net Capacity Cu. Ft. <sup>†</sup> |      |
| Shelves                           | -    |
| Barrels                           | -    |
| 20 oz. Bottles                    | -    |
| 12 oz. Bottles                    | -    |
| 12 oz. Cans                       | -    |
| 8" Mugs                           | -    |
| # of Pans (Top)                   | -    |
| # of Pans (Drawer)                | 1x10 |
| Dividers                          | -    |
| Trays                             | -    |

### ELECTRICAL DATA

|                      |            |
|----------------------|------------|
| Voltage              | 115-60-1   |
| Full Load Amperage   | 2A         |
| Feed Wires w/ Ground | 3          |
| Cord Length          | 9ft        |
| NEMA Plug Type       | NEMA 5-15P |

### REFRIGERATION DATA

|                     |       |
|---------------------|-------|
| Compressor          | Side  |
| Refrigerant         | R-290 |
| Compressor HP       | 1/3   |
| BTU/HR <sup>†</sup> | 2311  |

### KEY

|           |            |             |               |
|-----------|------------|-------------|---------------|
| <b>D</b>  | Door       | <b>R</b>    | Refrigerator  |
| <b>L</b>  | Lid        | <b>REF</b>  | Refrigerator  |
| <b>H</b>  | Half Door  | <b>F</b>    | Freezer       |
| <b>FD</b> | Full Door  | <b>FRZ</b>  | Freezer       |
| <b>SD</b> | Solid Door | <b>DUAL</b> | REF/FRZ Combo |
| <b>GD</b> | Glass Door | <b>DR</b>   | Drawer        |

|  |           |       |      |    |      |
|--|-----------|-------|------|----|------|
|  | Elevation | Right | Plan | 3D | Back |
|  |           |       |      |    |      |

### PLAN VIEW

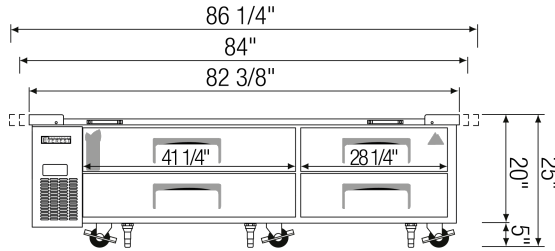

### FRONT

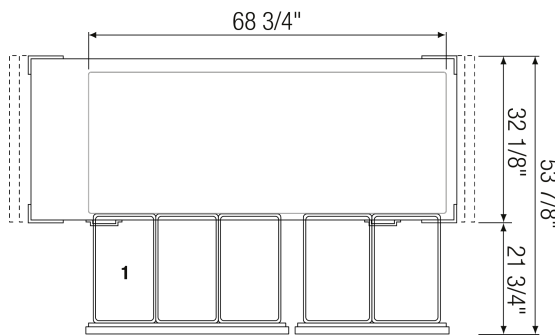

### TOP

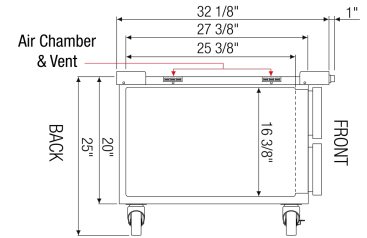

### SIDE

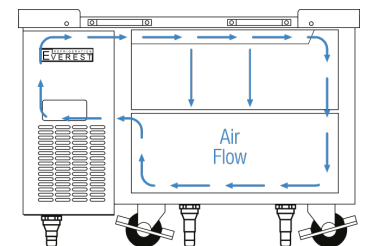

### AIRFLOW

### ACCESSORIES & OPTIONS

- AJL03-00 - Interchangeable Leg for Caster (Optional)
- CASA3-02 - 3" Overall Height Caster Assembly - (3) Front (3) Rear

(<sup>†</sup>)Based on evaporating temperature of 23°F (-5°C) & condensing temperature of 131°F (55°C). (<sup>‡</sup>) Product capacity is calculated based on standard industry figures. (<sup>\*</sup>) Reference plan view for clarification on caster/unit height. If dimensions and capacity are critical, please contact Everest Refrigeration. Blizzard R290 replacement is at the sole discretion of Everest Refrigeration. Specifications subject to change without notice.